



MEISHUO Building Materials CO.,Ltd

Office: No.2208, Huaqiao Square, Pukou district, Nanjing,China

Tel: 0086-025-58196288 Fax:0086-025-58196399

Website: www.msbox.com E-mail:sariel@msbox.com

MSD-QSJH EXPANSION JOINT SPEC DATA

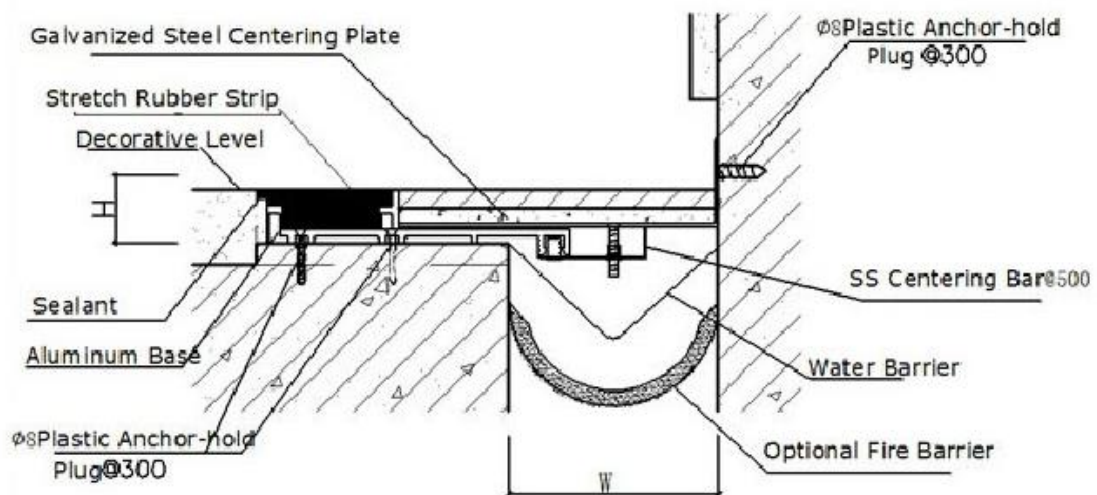
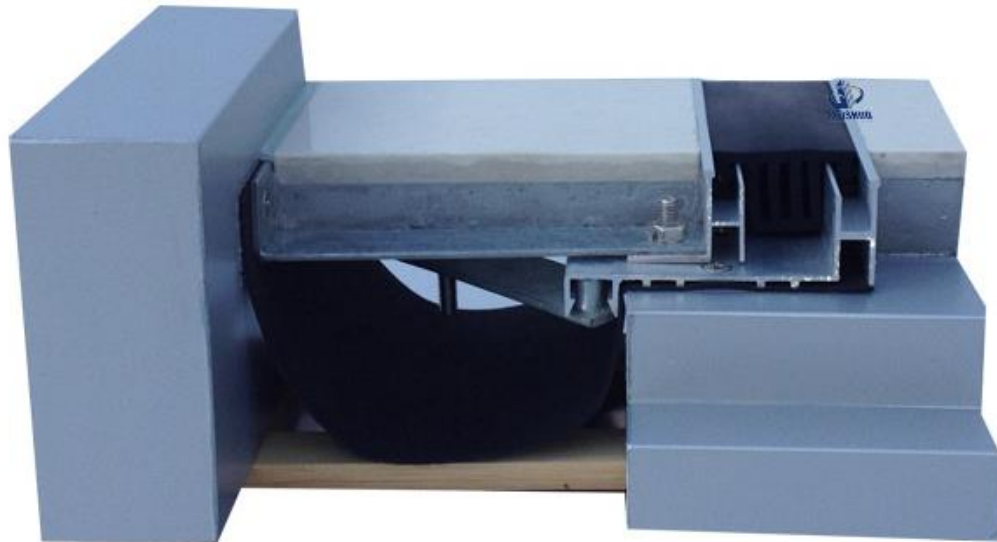

MSD-QSJH



MEISHUO Building Materials CO.,Ltd

Office: No.2208, Huaqiao Square, Pukou district, Nanjing,China

Tel: 0086-025-58196288 Fax:0086-025-58196399

Website: www.msbox.com E-mail:sariel@msbox.com

MSD-QSJH EXPANSION JOINT SPEC DATA

Product Description:

An architectural line of thermal and waterproof expansion joint systems meeting the aesthetic and structural demands of airports, hospitals, shopping malls and other building types.

- Featuring a Centering Bar System
- Dual seal design provides necessary movement ranges.
- Flush rubber gasket minimizes sightline
- Gaskets available in many coordinating designer colors.
- Snap-fit design for easy on-site assembly
- Flexible seals provide a secure fit and yet retain optimal flexibility
- Ideal for carpet, vinyl, ceramic tile and other floor finishes
- Be cost-effective with many different joint

BASIC USES:

Application: floor to wall

Joint Width(W)	50	100	150	200	250
Exposed Surface(ES)	119	169	219	269	319
Movement Capacity	13	13	13	13	13

TECHNICAL DATA:

MATERIALS:

Aluminum Base: ASTM 6063T5 Mill finish, anodisation



MEISHUO Building Materials CO.,Ltd

Office: No.2208, Huaqiao Square, Pukou district, Nanjing,China

Tel: 0086-025-58196288 Fax:0086-025-58196399

Website: www.msbox.com E-mail:sariel@msbox.com

Rubber color options: Black / Grey

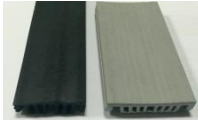

WARRANTY:

Meishuo warrants that its products are manufactured free of defects and conform to the technical data listed. Under this warranty, we will replace any material proven defective when applied in accordance with our written instructions for applications recommended by us as suitable for subject products. Meishuo shall not be liable for any injury, loss or damage, direct or consequential, arising out of the use of the product.